

# Linsen

$\omega_3$  fatty acids ( $\alpha$ -linolenic acid, Eicosapentaenoic acid, Docosahexaenoic acid),  
 $\omega_6$  fatty acids ( $\gamma$ -linoleic acid, Linolenic acid, Conjugated linoleic acids),  
Zinc and Vitamins involved in the metabolism of non-saturated fatty acids

## Complementary feed for dogs and cats

### Composition

Linseed oil, Fish oil, Borage oil, Conjugated linoleic acids (CLAs), Soy seed oil.

### Additives

*Nutritional additives:* Vitamin A 250,000 IU/l - Vitamin C 7,900 mg/l - Vitamin E 5,000 mg/l - Zinc oxide 2,730 mg/l (equal to Zinc 2,200 mg/l) - Vitamin B6 500 mg/l - Biotin 50 mg/l.

### Analytical constituents

Crude oils and fats 95%, Crude protein 0%, Crude fibre 0%, Crude ash 0.3%

### Instruction for proper use

Shake vigorously before use, so that the sediment can be completely dispersed.

Dog - initially: 5 ml per 10 kg bodyweight per day for 15 days

Maintenance: 2.5 ml per 10 kg bodyweight per day

Cat - initially: 0.5 ml every kg bodyweight per day for 15 days

Maintenance: 0.25 ml every kg bodyweight per day

Use the supplied graduated syringe or, alternatively, remember that:

1 coffee spoon equals about 2 ml

1 tea spoon equals about 3 ml

1 soup spoon equals about 10 ml

Administer the indicated quantities over the meals, mixed with dry or wet feed.

In order to avoid the onset of loose stools, gradually reach the full dosage (5 ml per 10 kg of bodyweight) over 3-4 days. In case of loose stools in animals that are susceptible to oils, halve the dosage.

**The benefits from the use of Linsen depend on the time that is required to obtain a balanced  $\omega_6$ : $\omega_3$  ratio in the sites involved in inflammatory process.**

The product must be used for at least one month. The product must be administered continuously or in cycles, according to the indications of the veterinary surgeon.

The indicated quantities ensure compliance with the maximum daily amount of each additive.

## INSTRUCTIONS FOR THE USE OF THE SYRINGE

After opening the bottle, push the bung with the syringe deep into the bottle neck. While keeping the plunger fully pushed, vigorously shake the bottle and turn it upside down.

Firmly hold the bottle, the bung and the syringe and slowly pull the plunger down, drawing the solution until the desired mark on the scale is reached. Do not pull abruptly: the plunger may come off the syringe, and the syringe come off the bung.

Turn the bottle back the right way up and extract the syringe by rotating it.

Squirt the contents onto the feed or directly into the mouth of the animal.

If one draw is not enough to obtain the necessary quantity, repeat the operation.

After use, rinse carefully the plunger and the syringe with water and dry them well with blotting paper.

Close the bottle by screwing the cap back on.

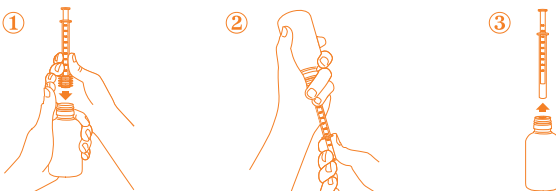

**Manufactured and packaged by:** Teknofarma S.r.l.  
Str. Com. da Bertolla all'Abbadia di Stura,14 - Turin  
Identification n.  $\alpha$  IT 000146TO - ABP4819PETPP3  
[www.teknofarma.com](http://www.teknofarma.com)

#### **PACKING**

120 ml bottle  
200 ml bottle

Keep out of reach of children and pets.

Keep the bottle well closed, away from the light and below 30 °C.

Shelf life after first opening: 3 months.

**Batch n. / Best before:** see the top of the box.

---

#### **INDICATIONS**

The product is used to correct the diet of dogs and cats in case of chronic conditions, such as allergy, atopy, asthma, arthritis, coronary artery disease, arteriosclerosis, kidney failure, where a high intake of  $\omega_3$  polyunsaturated fatty acids can help to control the inflammatory process.

**5 ml of Linsen contain:** polyunsaturated fatty acids (PUFAs) 2543 mg (Essential fatty acids: linoleic acid 617 mg, alpha-linolenic acid 1036 mg - Other polyunsaturated fatty acids: gamma-linolenic acid (GLA) 123 mg, eicosapentaenoic acid (EPA) 360 mg, docosahexaenoic acid (DHA) 187 mg, conjugated linoleic acids 220 mg), Vitamin A 1250 IU, Vitamin E 25 mg, Vitamin B6 2.5 mg, Vitamin C 39.5 mg, Biotin 250  $\mu$ g, Zinc 11 mg.

**Supply per 1 kg of bodyweight:** polyunsaturated fatty acids (PUFAs) 254.3 mg (Essential fatty acids: linoleic acid 61.7 mg, alpha-linolenic acid 103.6 mg - Other polyunsaturated fatty acids: gamma-linolenic acid (GLA) 12.3 mg, eicosapentaenoic acid (EPA) 36.0 mg, docosahexaenoic acid (DHA) 18.7 mg, conjugated linoleic acids 22 mg), Vitamin A 125 IU, Vitamin E 2.5 mg, Vitamin B6 0.25 mg, Vitamin C 3.95 mg, Biotin 25  $\mu$ g, Zinc 1.1 mg.

#### **PROPERTIES**

The modulation of many inflammatory conditions - particularly chronic ones such as allergy, atopy, asthma, arthritis, arteriosclerosis, coronary artery disease, kidney failure - is currently supported also by correcting the diet and/or supplementing it with missing or lacking constituents, whose effectiveness in contrasting these situations has been scientifically proven.

Essential fatty acids and polyunsaturated fatty acids, particularly  $\omega_3$  ones, have a fundamental role in fighting chronic inflammatory conditions. The ratio between the quantity of  $\omega_6$  acids (linoleic acid series) and  $\omega_3$  (linolenic acid series) included in the diet is particularly important.

Recent research on the physiological role of polyunsaturated fatty acids has shown that the intake of  $\alpha$ -linolenic acid and its derivatives in the  $\omega_3$  series in modern diets is no longer sufficient, as fats are taken mostly from vegetable fats that contain especially linoleic acid ( $\omega_6$ ).

Linsen contains adequate quantities of  $\alpha$ -linolenic acid and its derivatives of the  $\omega_3$  series (contained especially in fish) that have already been biologically processed (Eicosapentaenoic acid and Docosahexaenoic acid). These quantities are enough to shift the  $\omega_6$ : $\omega_3$  ratio in the diet towards more balanced values, which are more effective in modulating inflammatory states.

Linsen also contains conjugated linoleic acids (CLAs) in the concentration that is currently considered as optimal to reduce inflammatory mediators.

Linsen contains a combination of natural oils that provide essential fatty acids in the form of easily digestible and absorbable triglycerides.

Biotin and Vitamin B<sub>6</sub> are essential for the biochemical reactions necessary to transform essential fatty acids into longer chain and more desaturated fats.

Vitamins A, E, C and Zinc protect the epithelium and have antioxidant properties, essential to protect biological membranes from the action of free radicals.

In particular, the regular intake of Vitamin E fights the overproduction of the immunoglobulins involved in allergies, and reduces the release of inflammatory mediators.